

# LAVINA

by  SUPERABRASIVE

## OPERATOR'S QUICK GUIDE L19 S7 ELECTRIC GRINDERS

### TRANSPORTING AND LIFTING

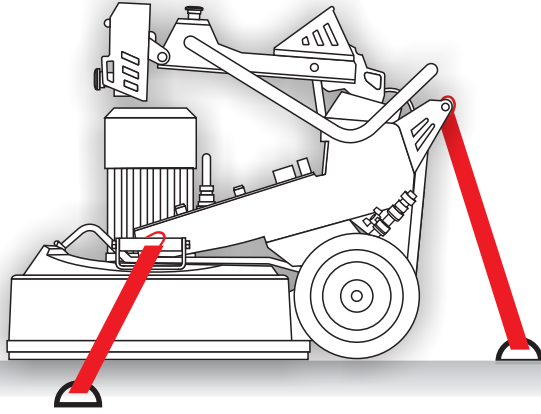

TO TRANSPORT THE MACHINE, USE THE HANDLES OF THE GRINDING HEAD AND THE REAR BAR AS ANCHORING POINTS FOR STRAPPING THE MACHINE DURING TRANSPORTATION.

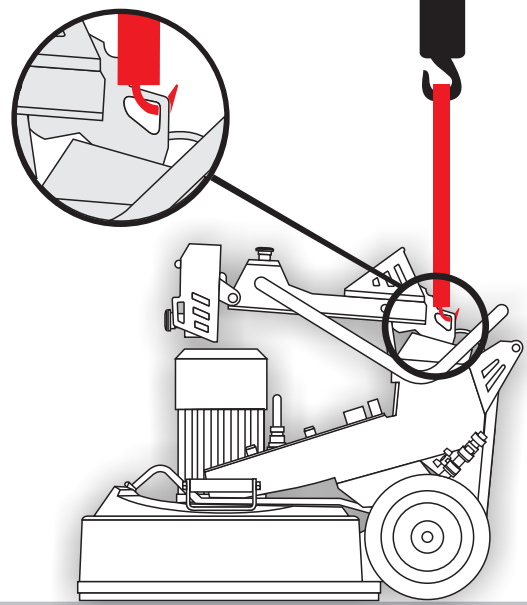

THE CARRIAGE HAS A LIFTING POINT, SITUATED JUST UNDER THE HANDLEBAR AS IT'S SHOWN ON THE IMAGE.

### HANDLE ADJUSTMENT

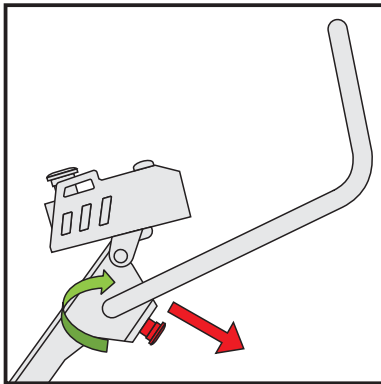

THE MACHINE IS EQUIPPED WITH TWO LOCKING MECHANISMS – ONE FOR THE HANDLES AND ONE FOR THE WHOLE HANDLEBAR. PULL THE KNOB (RED ARROW) AND ROTATE THE HANDLES TO THE DESIRED POSITION.

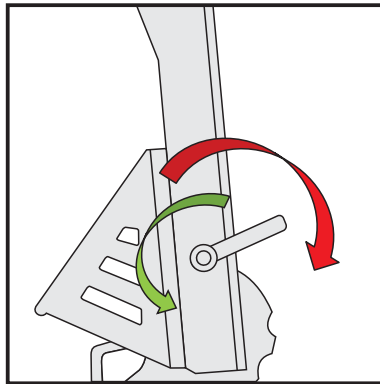

TO ROTATE THE WHOLE HANDLEBAR USE THE LEVER (RED ARROW FOR LOCK DIRECTION) AND (GREEN ARROW FOR UNLOCK DIRECTION).

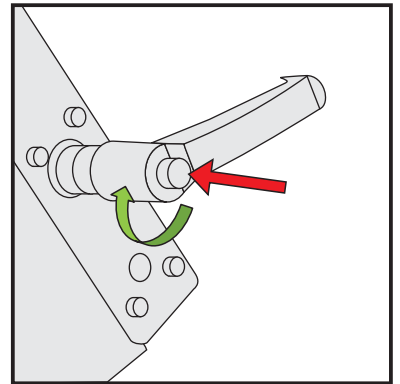

THE HANDLE IS ADJUSTABLE. TO SET IT INTO MORE CONVENIENT POSITION PRESS THE BUTTON AND ROTATE THE LEVER.

REGISTER YOUR MACHINE WARRANTY WITHIN 30 DAYS OF PURCHASE - SCAN THE QR CODE OR GO TO [SUPERABRASIVE.COM / WARRANTY-REGISTRATION](http://SUPERABRASIVE.COM/WARRANTY-REGISTRATION)



DOWNLOAD YOUR MACHINE MANUAL AT [SUPERABRASIVE.COM / MACHINE-MANUALS](http://SUPERABRASIVE.COM/MACHINE-MANUALS), OR SCAN THE QR CODE.



# CONTROL BOARD

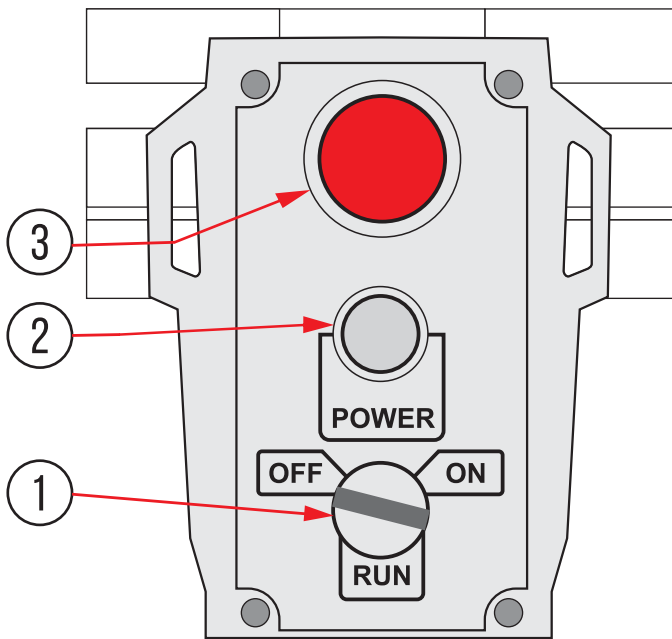

1. START/STOP SWITCH – TURN THE MACHINE ON AND OFF.
2. POWER INDICATOR – GLOWS WHEN THE MACHINE IS PLUGGED INTO POWER SUPPLY.
3. EMG STOP BUTTON – IMMEDIATELY STOPS THE MACHINE IN CASE OF EMERGENCY.

# TOOL MOUNTING POSITION

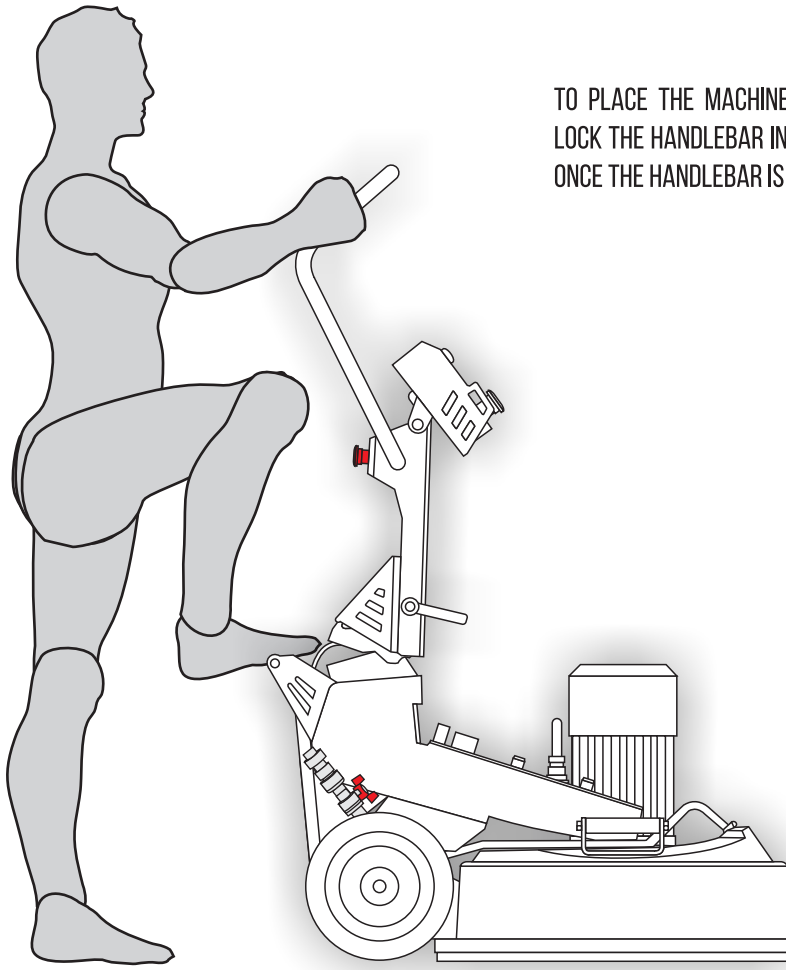

TO PLACE THE MACHINE IN THE TOOL MOUNTING POSITION, LOCK THE HANDLEBAR IN THE VERTICAL POSITION AS SHOWN. ONCE THE HANDLEBAR IS SET TILT THE MACHINE BACKWARDS.

# TOOL MOUNTING

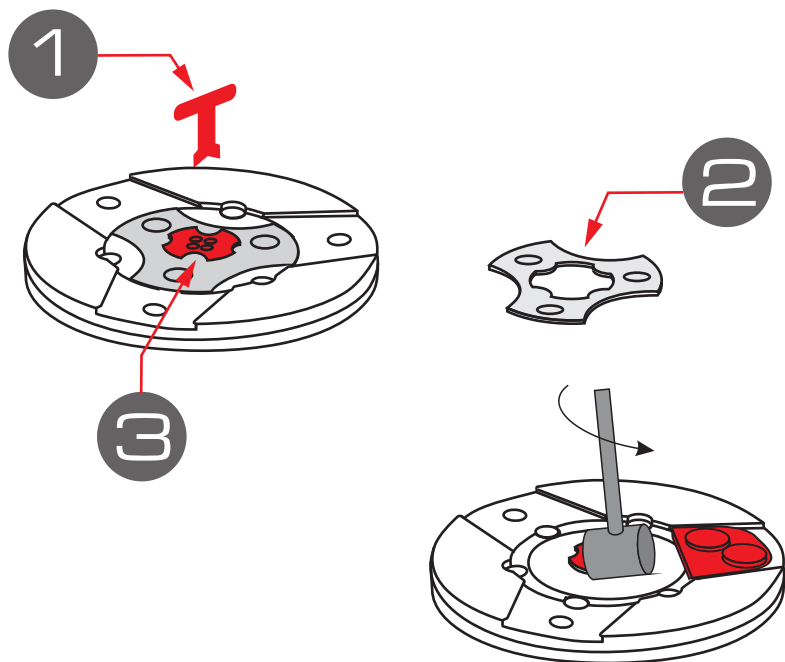

USE THE TOOL HOLDER KEY / 1 / TO ROTATE THE KEY LOCK / 3 / IN ORDER TO UNLOCK AND REMOVE SECURITY PLATE / 2 /.

PLACE THE QUICKCHANGE TOOLS INTO THE TRAPEZOID SLOTS, PUT THE SECURITY PLATE BACK AS SHOWN, AND ROTATE THE KEY LOCK TO LOCK THE SECURITY PLATE.

# WATER SYSTEM

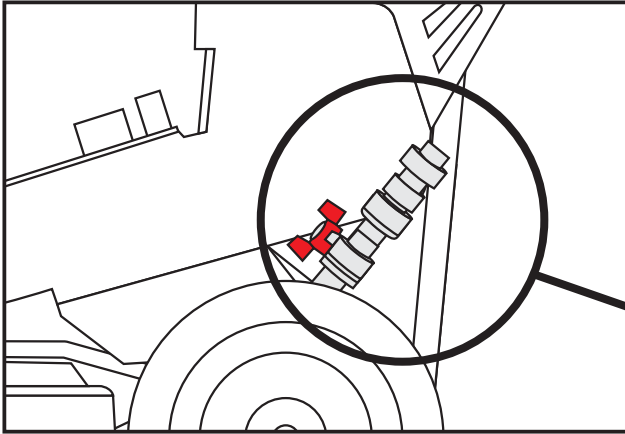

THE MACHINE IS EQUIPPED WITH QUICK CONNECT HOSE FITTING AND A VALVE TO CONTROL THE WATER FLOW.

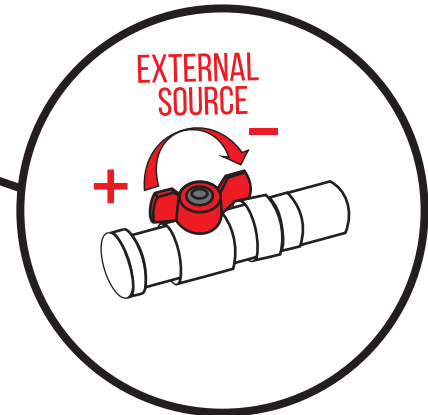

# CONNECTING A VACUUM

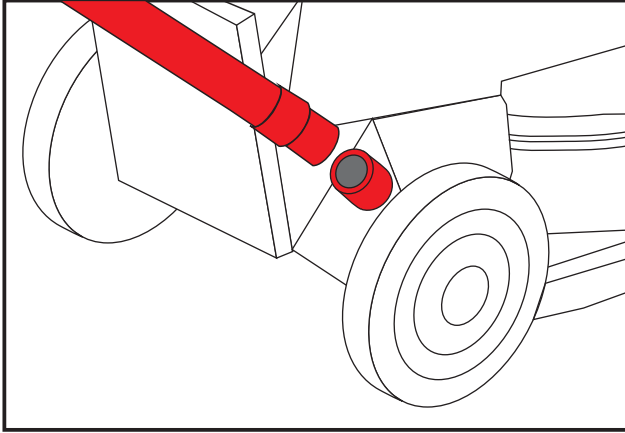

THE VACUUM HOSE PORT IS SITUATED ON THE BACK OF THE MACHINE.

IT HAS A DIAMETER OF 50 MM OR 2 INCHES.