

# LAVINA

by  SUPERABRASIVE

## OPERATOR'S QUICK GUIDE PROPANE GRINDERS

### TRANSPORTING AND LIFTING

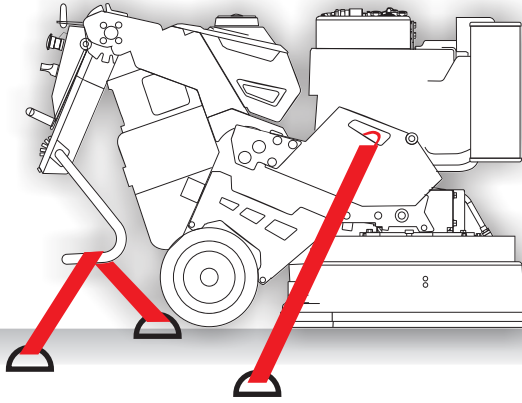

USE THE WEIGHT HANDLES AND THE HANDLEBAR AS ANCHORING POINTS DURING TRANSPORTATION. MAKE SURE MACHINE IS SECURELY ANCHORED, AND GRINDING HEAD COVER IS LOWERED DOWN / LOCKED. TIGHTEN THE STRAPS OVER NON-MOVING PARTS, E.G. MACHINE CHASSIS.

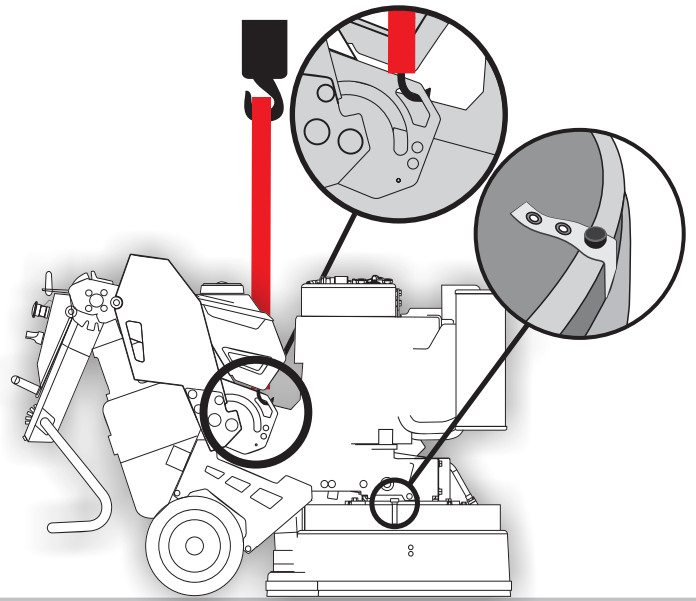

LAVINA MACHINES HAVE TWO LIFT POINTS. WHEN LIFTING MACHINE, MAKE SURE THE WEIGHTS ARE IN BACKWARDS POSITION, AND THE GRINDING HEAD COVER IS RAISED / LOCKED IN TRANSPORT POSITION.

### HANDLE ADJUSTMENT

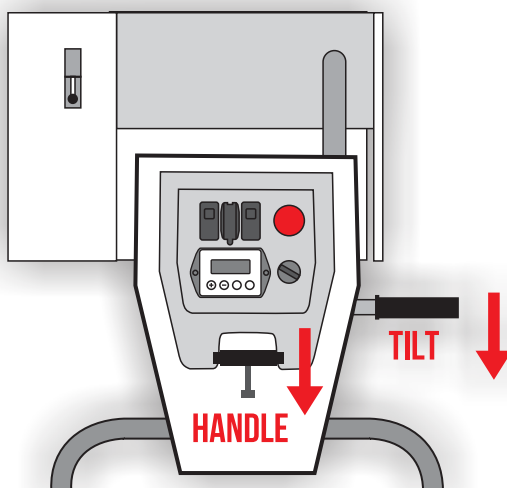

THE MACHINE IS EQUIPPED WITH TWO LOCKING MECHANISMS – ONE FOR TILT AND ONE FOR HANDLE ADJUSTMENT. PULL THE LEVER TOWARDS OPERATOR TO UNLOCK AND ADJUST TILT / HANDLE TO DESIRED POSITION. THE MECHANISM LOCKS ITSELF BACK.

#### IMPORTANT!

IF THE LOCKING MECHANISMS START MAKING NOISE OR MOVE ROUGHLY, LUBRICATION IS RECOMMENDED. CHECK YOUR MACHINE MANUAL FOR LUBRICANT TYPE.

REGISTER YOUR MACHINE WARRANTY WITHIN 30 DAYS OF PURCHASE - SCAN THE QR CODE OR GO TO [SUPERABRASIVE.COM / WARRANTY-REGISTRATION](http://SUPERABRASIVE.COM/WARRANTY-REGISTRATION)



DOWNLOAD YOUR MACHINE MANUAL AT [SUPERABRASIVE.COM / MACHINE-MANUALS](http://SUPERABRASIVE.COM/MACHINE-MANUALS), OR SCAN THE QR CODE.



# WEIGHTS

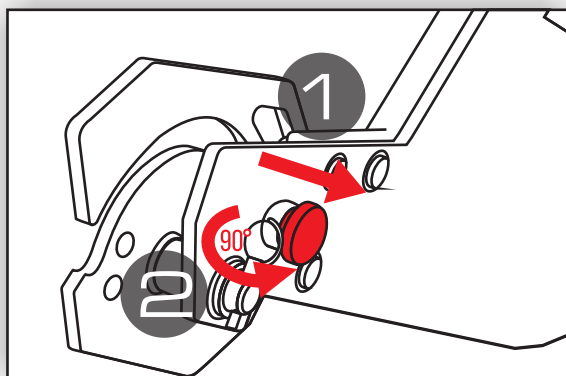
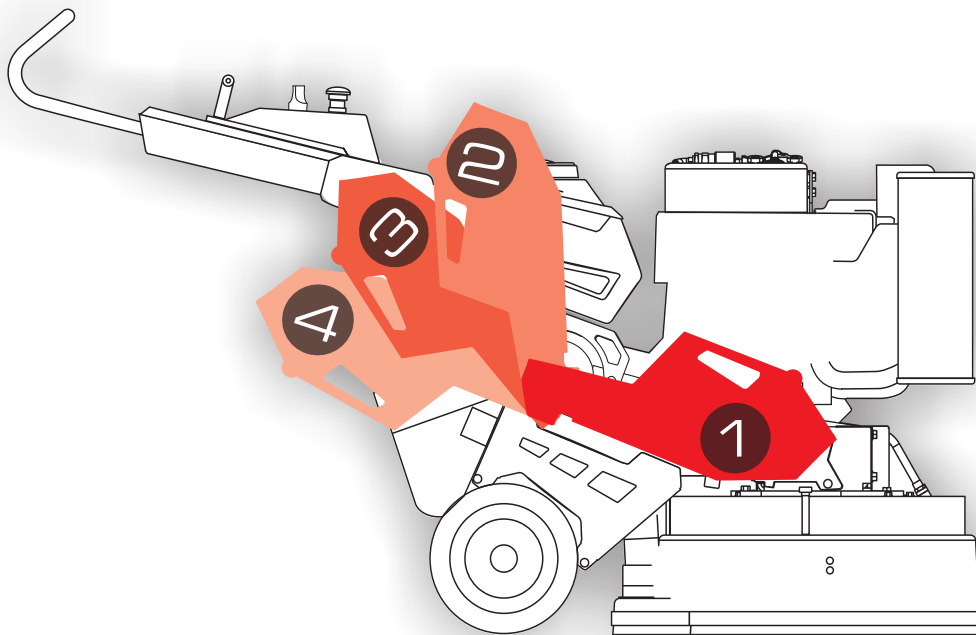

TO MOVE THE WEIGHTS, RELEASE THE LOCKING KNOB BY PULLING IT, AND THEN RELEASE IT TO LOCK INTO THE NEW DESIRED POSITION.

THE LOCKING KNOB HAS A REST POSITION. PULL IT TO UNLOCK AND ROTATE TO 90 DEGREES - IN THIS POSITION, THE WEIGHTS ARE FREE TO MOVE.

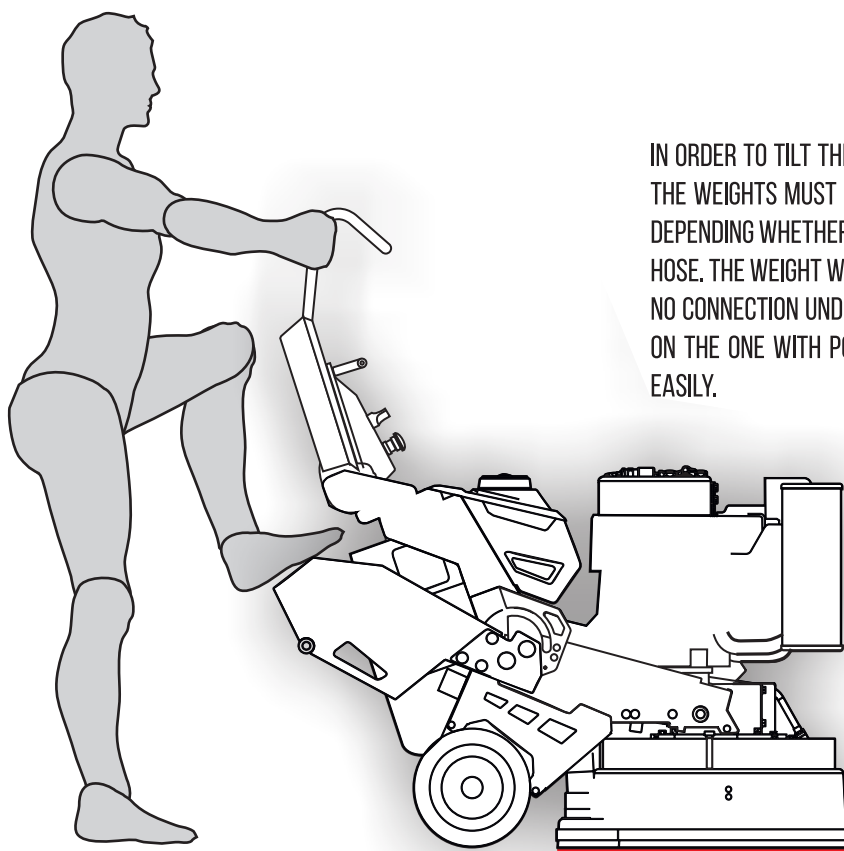

IN ORDER TO TILT THE MACHINE FOR TOOL CHANGE. ONE OF THE WEIGHTS MUST BE IN POS.4 AND THE OTHER IN POS. 3 DEPENDING WHETHER YOU ARE USING WATER HOSE OR DUST HOSE. THE WEIGHT WITH POSITION 4 MUST BE THE ONE WITH NO CONNECTION UNDERNEATH IT. THE OPERATOR CAN STEP ON THE ONE WITH POS. 4 IN ORDER TO TILT THE MACHINE EASILY.

# TOOL MOUNTING

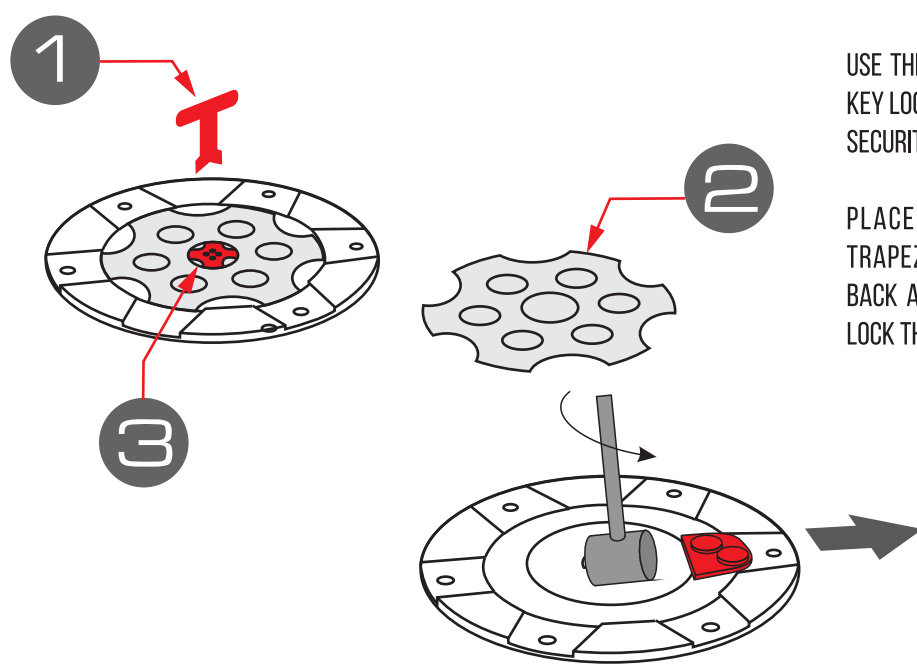

USE THE TOOL HOLDER KEY / 1 / TO ROTATE THE KEY LOCK / 3 / IN ORDER TO UNLOCK AND REMOVE SECURITY PLATE / 2 /.

PLACE THE QUICKCHANGE TOOLS INTO THE TRAPEZOID SLOTS, PUT THE SECURITY PLATE BACK AS SHOWN, AND ROTATE THE KEY LOCK TO LOCK THE SECURITY PLATE.

# WATER SYSTEM

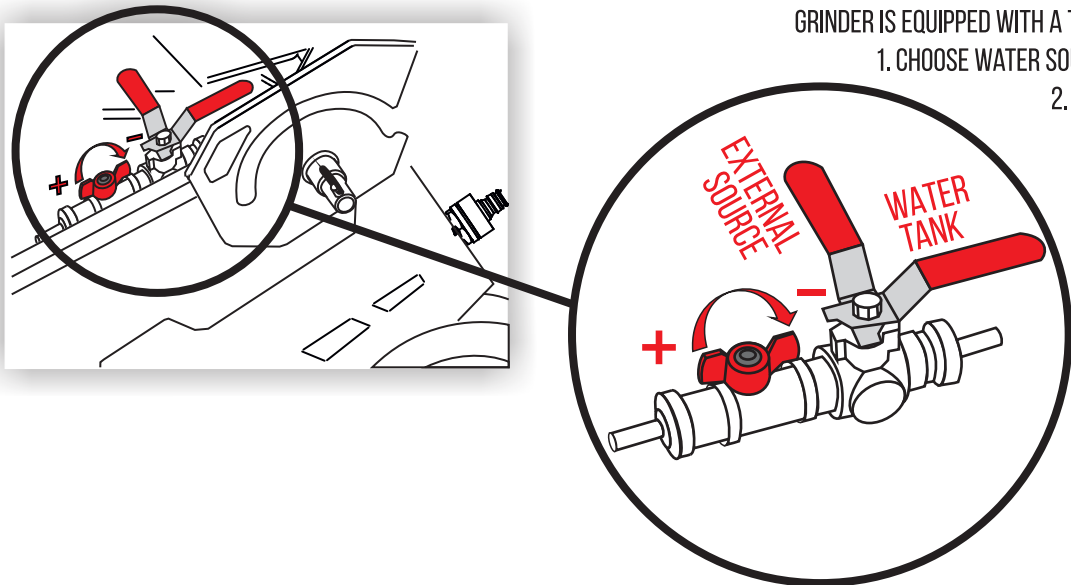

GRINDER IS EQUIPPED WITH A TWO-WAY WATER TAP.  
1. CHOOSE WATER SOURCE - TANK OR HOSE.  
2. ADJUST WATER FLOW.

# CONNECTING A VACUUM

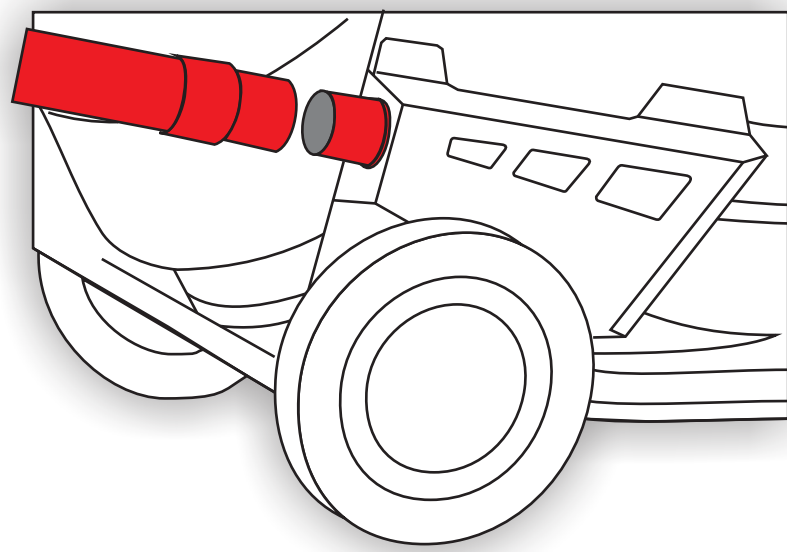

THE VACUUM HOSE PORT IS SITUATED ON THE BACK OF THE MACHINE.  
IT HAS A DIAMETER OF 50 MM OR 2 INCHES.

# CONTROL BOARD

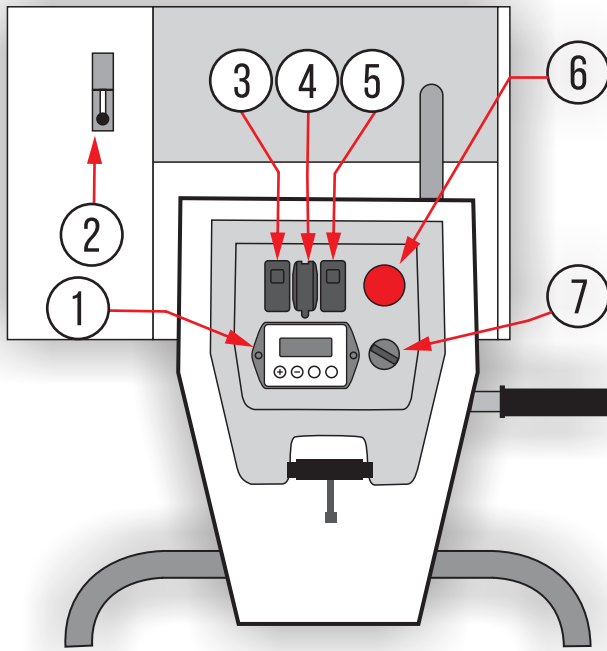

1. ELECTRONIC MODULE
2. THROTTLE CONTROLLER
3. ENGAGE / DISENGAGE CLUTCH
4. USB PORT
5. LIGHTS SWITCH
6. EMERGENCY STOP BUTTON
7. START / STOP ENGINE SWITCH

# STARTING MACHINE

**USE ONLY VAPOR PROPANE TANKS. DO NOT FILL TANK OVER 80%.**  
USING A LPG TANK (USED ON FORKLIFTS) WILL PREVENT ENGINE FROM STARTING AND WORKING PROPERLY, AND RESULT IN DAMAGING THE PRESSURE REGULATOR.

WHEN DONE WORKING, STORE PROPANE TANK OUTSIDE THE BUILDING, IN A SECURE PLACE, AWAY FROM HEAT OR DIRECT SUNLIGHT.

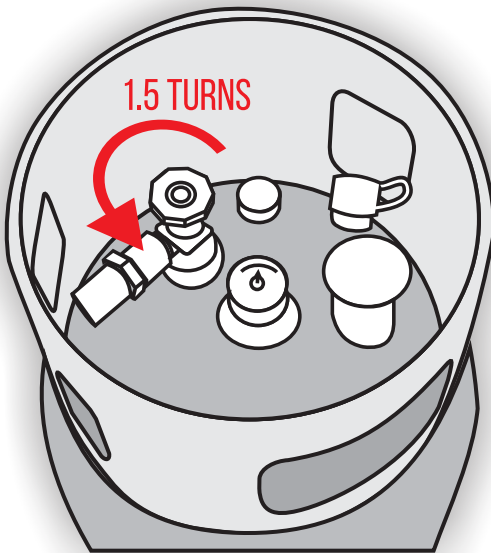

- CONNECT THE RED BATTERY CONNECTOR BEFORE STARTING MACHINE (PROPANE & REMOTE-CONTROL MODELS).
- CHECK OIL LEVEL & FOLLOW MANUAL INSTRUCTIONS.
- OPEN THE SERVICE VALVE ON THE PROPANE TANK ABOUT ONE AND A HALF (COUNTERCLOCKWISE) TURNS.
- SET THE THROTTLE LEVER TO APPROX. 1/5 OF ITS MOVEMENT CAPABILITY. DON'T START ENGINE AT FULL THROTTLE!
- ENGAGE START/STOP SWITCH FOR 5-6 SEC. MAX, OR UNTIL THE ENGINE FIRES. IF THIS IS EXCEEDED, SERIOUS DAMAGE WILL RESULT, AND THE WARRANTY MAY BE VOID.
- OPERATE THE ENGINE AT HALF THROTTLE FOR APPROX. 2 MIN. TO PROPERLY WARM ENGINE. THEN, ADVANCE TO FULL THROTTLE.
- HOLD THE MACHINE FIRMLY AND PUSH CLUTCH BUTTON IN ORDER TO ENGAGE THE CLUTCH AND START WORKING.

# STOPPING MACHINE

STOPPING THE MACHINE MUST BE DONE GRADUALLY.

- DISENGAGE THE CLUTCH BY PUSHING THE CLUTCH SWITCH AND RETURN THROTTLE TO IDLE.
- WAIT 5-10 SECONDS.
- TURN THE START/STOP SWITCH FULLY TO THE LEFT TO ARREST THE ENGINE. ONLY IN CASE OF EMERGENCY, PRESS THE EMERGENCY STOP BUTTON.
- CLOSE THE SERVICE VALVE ON THE PROPANE TANK.
- DISCONNECT THE BATTERY TO AVOID BATTERY DRAIN.