

# LAVINA

by  SUPERABRASIVE

## OPERATOR'S QUICK GUIDE ELECTRIC GRINDERS

### TRANSPORTING AND LIFTING

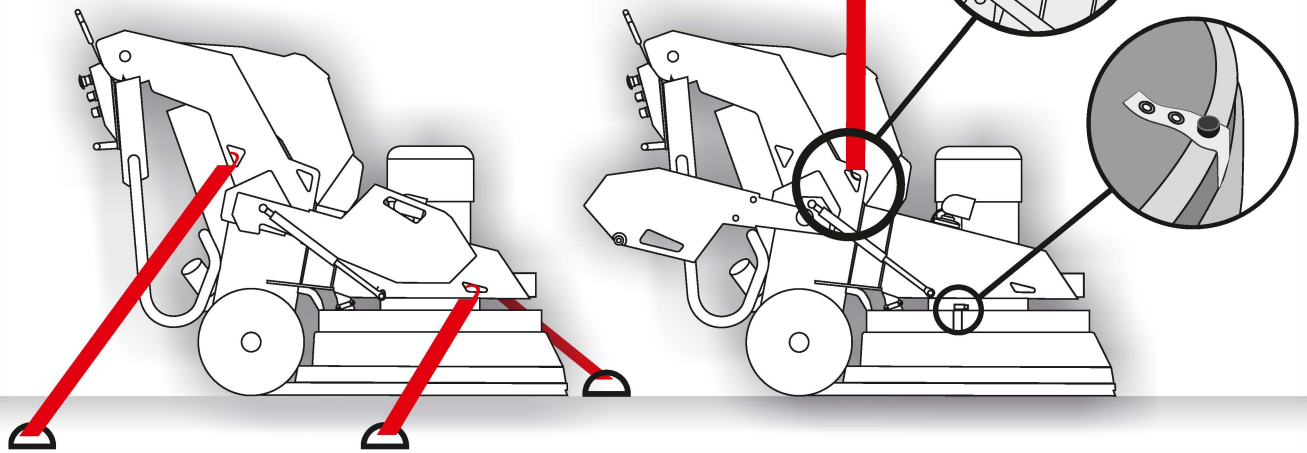

LAVINA MACHINES HAVE FOUR ANCHORING POINTS FOR STRAPPING DURING TRANSPORTATION. MAKE SURE MACHINE IS SECURELY ANCHORED, AND GRINDING HEAD COVER IS LOWERED DOWN / LOCKED. TIGHTEN THE STRAPS OVER NON-MOVING PARTS, E.G. MACHINE CHASSIS.

LAVINA MACHINES HAVE TWO LIFT POINTS. WHEN LIFTING MACHINE, MAKE SURE THE WEIGHTS ARE IN BACKWARDS POSITION, AND THE GRINDING HEAD COVER IS RAISED / LOCKED IN TRANSPORT POSITION.

### HANDLE ADJUSTMENT

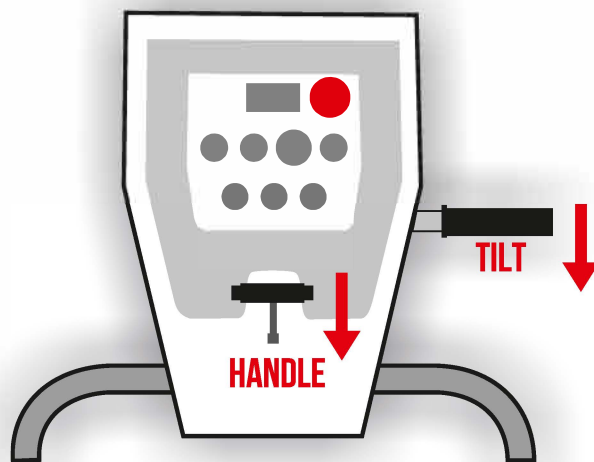

THE MACHINE IS EQUIPPED WITH TWO LOCKING MECHANISMS – ONE FOR TILT AND ONE FOR HANDLE ADJUSTMENT. PULL THE LEVER TOWARDS OPERATOR TO UNLOCK AND ADJUST TILT / HANDLE TO DESIRED POSITION. THE MECHANISM LOCKS ITSELF BACK.

#### IMPORTANT!

IF THE LOCKING MECHANISMS START MAKING NOISE OR MOVE ROUGHLY, LUBRICATION IS RECOMMENDED. CHECK YOUR MACHINE MANUAL FOR LUBRICANT TYPE.

REGISTER YOUR MACHINE WARRANTY WITHIN  
30 DAYS OF PURCHASE - SCAN THE QR CODE  
OR GO TO [SUPERABRASIVE.COM /  
WARRANTY-REGISTRATION](http://SUPERABRASIVE.COM/WARRANTY-REGISTRATION)



DOWNLOAD YOUR MACHINE MANUAL AT  
[SUPERABRASIVE.COM /MACHINE-MANUALS](http://SUPERABRASIVE.COM/MACHINE-MANUALS),  
OR SCAN THE QR CODE.



# WEIGHTS

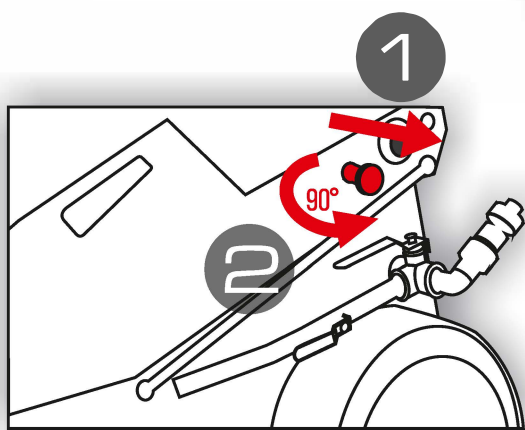
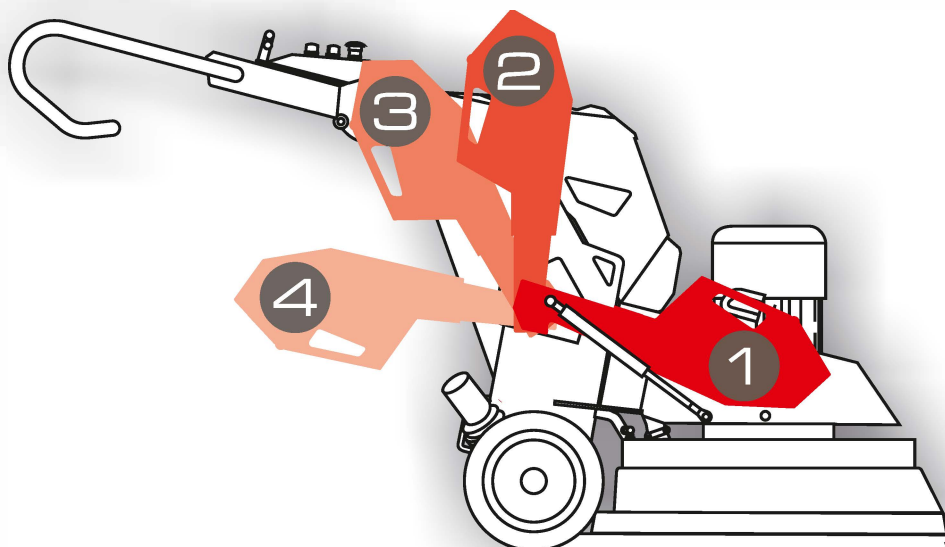

TO MOVE THE WEIGHTS, RELEASE THE LOCKING KNOB BY PULLING IT, AND THEN RELEASE IT TO LOCK INTO THE NEW DESIRED POSITION.

THE LOCKING KNOB HAS A REST POSITION. PULL IT TO UNLOCK AND ROTATE TO 90 DEGREES - IN THIS POSITION, THE WEIGHTS ARE FREE TO MOVE.

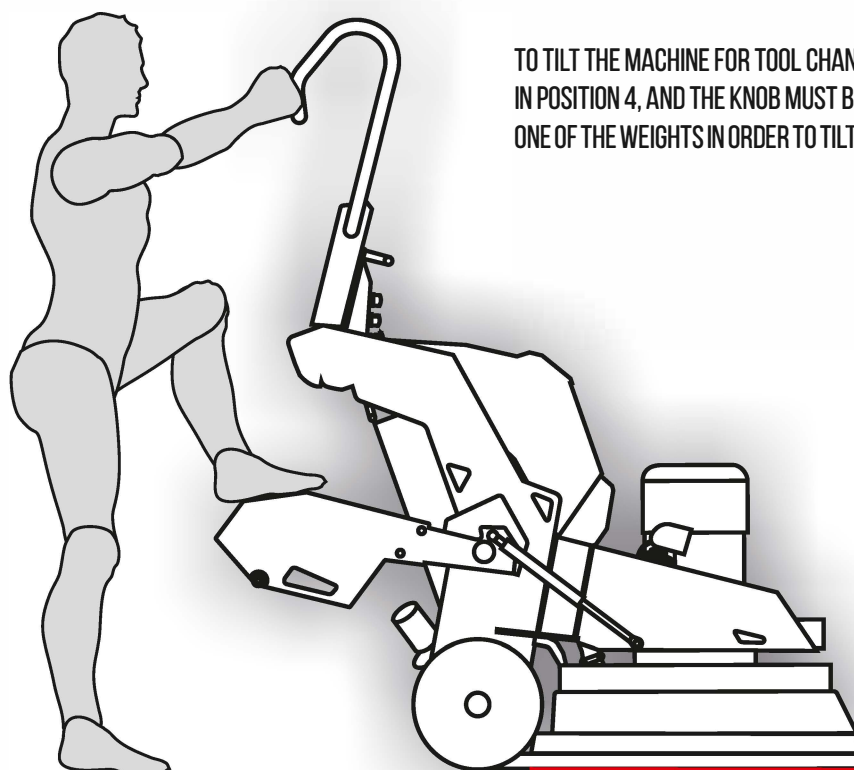

TO TILT THE MACHINE FOR TOOL CHANGES, THE WEIGHTS MUST BE IN POSITION 4, AND THE KNOB MUST BE IN REST POSITION. STEP ON ONE OF THE WEIGHTS IN ORDER TO TILT THE MACHINE EASILY.

# TOOL MOUNTING

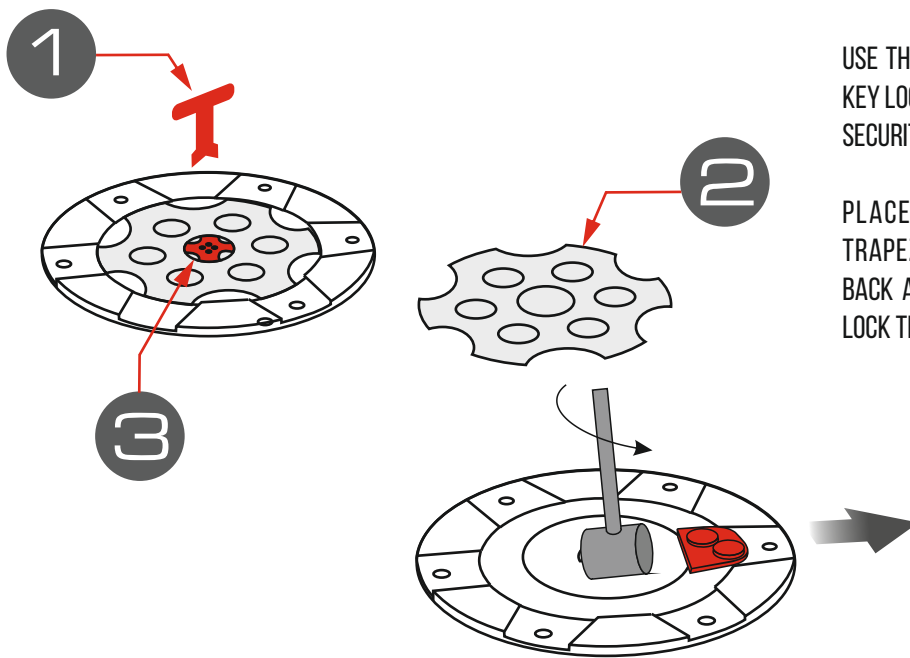

USE THE TOOL HOLDER KEY / 1 / TO ROTATE THE KEY LOCK / 3 / IN ORDER TO UNLOCK AND REMOVE SECURITY PLATE / 2 /.

PLACE THE QUICKCHANGE TOOLS INTO THE TRAPEZOID SLOTS, PUT THE SECURITY PLATE BACK AS SHOWN, AND ROTATE THE KEY LOCK TO LOCK THE SECURITY PLATE.

# WATER SYSTEM

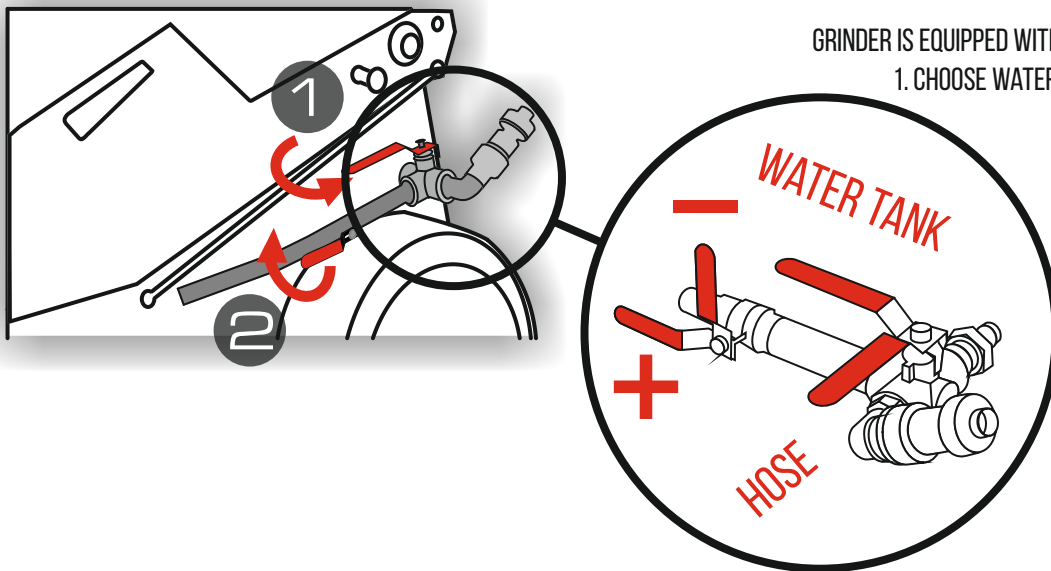

GRINDER IS EQUIPPED WITH A TWO-WAY WATER TAP.  
1. CHOOSE WATER SOURCE - TANK OR HOSE.  
2. ADJUST WATER FLOW.

# CONNECTING A VACUUM

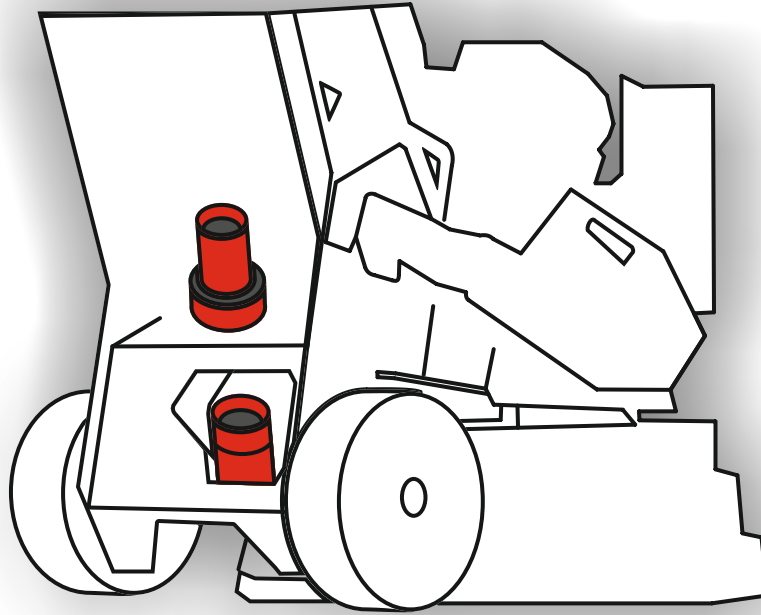

IF WORKING DRY, CONNECT A VACUUM.  
GRINDER IS EQUIPPED WITH A CAMLOCK FITTING:

2.5" E250 ON 25" MACHINES

3" E300 ON 30" MACHINES

# CONTROL BOARD

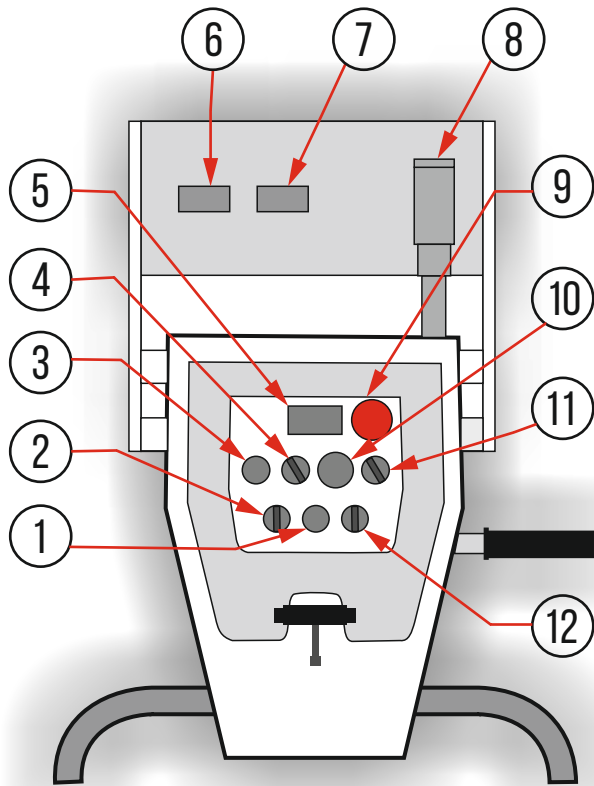

1. POWER INDICATOR
2. READY ON/OFF
3. RESET ALARMS
4. LIGHTS ON/OFF
5. TACHOMETER (TOOL HOLDER RPM)
6. USB PORT
7. HOUR METER
8. POWER PLUG
9. EMERGENCY STOP BUTTON
10. POTENTIOMETER
11. FORWARD / REVERSE
12. RUN / STOP

# STARTING MACHINE

PLUG THE MACHINE INTO POWER SUPPLY (8)  
- THE POWER INDICATOR MUST GLOW IN GREEN. (1)

TURN THE "READY ON/OFF" SWITCH TO ON TO POWER THE CONTROL BOARD. (2)

USE THE "RUN / STOP" SWITCH TO RUN THE MACHINE. (12)

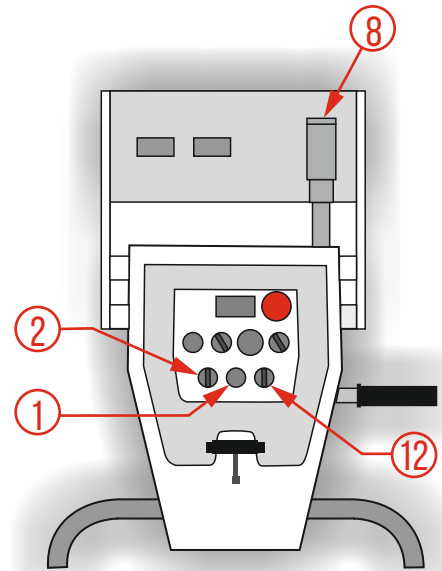

# STOPPING MACHINE

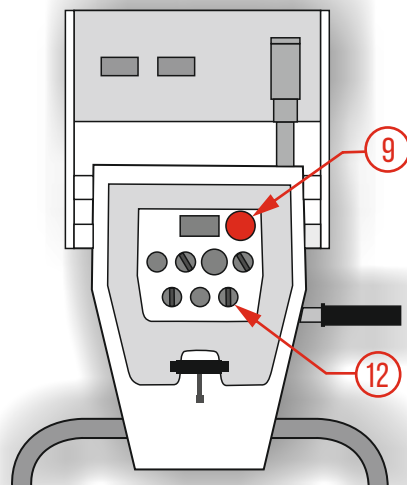

USE THE "RUN / STOP" SWITCH (12)  
OR THE EMERGENCY STOP BUTTON (9) TO STOP THE MACHINE.

**IN CASE OF EMERGENCY, ALWAYS PRESS THE EMERGENCY STOP BUTTON.**